

# Product Profile Dimensions

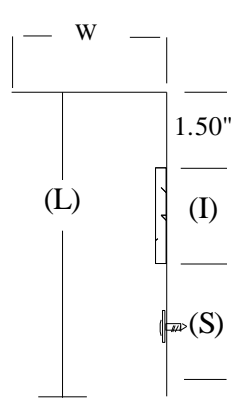

## PS16 - "ISA" (Inside Angle) slotted/vertical and solid horizontal legs

Composite Fire Stop/Framing for use in up to 2 hr rated wall assemblies. Provides 100% unencumbered joint protection accommodating up to 1 1/2" overall movement with level III (seismic) certification. Minimum G40 (20ga) and G60 (18ga and heavier) coating used for "parallel to beam" conditions, accommodate 1 1/2 z-clips, and fireproofing materials, providing slots 1" O/C for permanent attachment of studs per listed assemblies in UL Fire Resistance Directory.

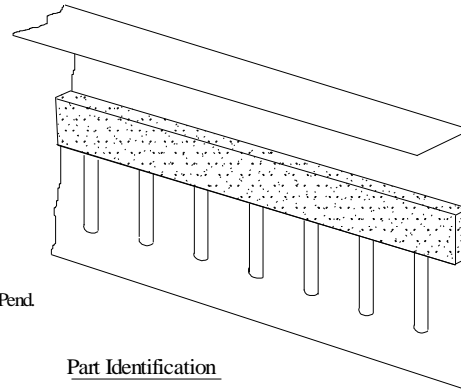
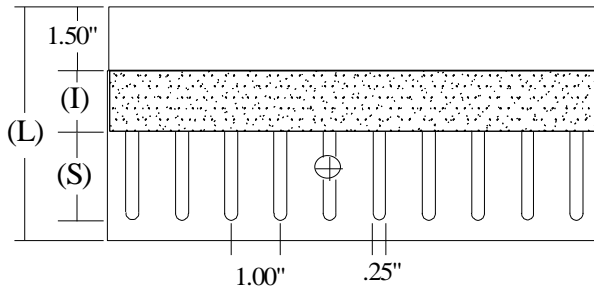

**Widths (W)**

- 200 (2")
- 400 (4")
- 600 (6")
- 800 (8")

**Gauge**

- .030 (20)
- .033 (20)
- .043 (18)
- .054 (16)

Part Identification

Example: 400ISA - 30

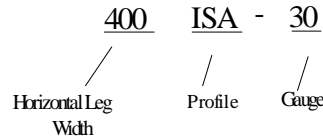

Profile	Leg Length (L)	Strip Width (I)	Slot Height (S)	Joint Protection
ISA	4.50"	1.00"	1.50"	.75"
ISAW	4.50"	1.25"	1.50"	1.00"
ISAX	5.50"	1.75"	2.00"	1.50"

**UL, ASTM & Code Standards**

UL2079, E814, E1966, ULC S115-M95  
 A1003, A653, A924, C645, C754, C955  
 AISI 2004 NAS  
 2006 & 2009 IBC  
 2007 CBC

**Lead Points**

MR 2.1 & 2.2 - Construction Waste: up to 2pts  
 MR 4.1 & 4.2 - Recycled Content: up to 2pts  
 MR 5.1 & 5.2 - Regional Proximity  
 EQ 4.1 - Low Emitting Materials  
 EQ 9 - Enhanced Acoustical

Phone: (425) 869-2811 Fax: (425) 869-2300