

# Unprotected "Bare" Fluted Substrate



## UD7 - Offset Under Valley Flute Cover (FC) Unprotected Deck

Joint Movement Capabilities (MC) / Profile Series design based on UL Listing: [HW-D-0544](#)

3/4" MC - (Stock Series)      1" MC - ("W" Series)      1 1/2" MC - ("X" Series)

2" MC - ("Z" Series)      3" MC - ("Y" Series)

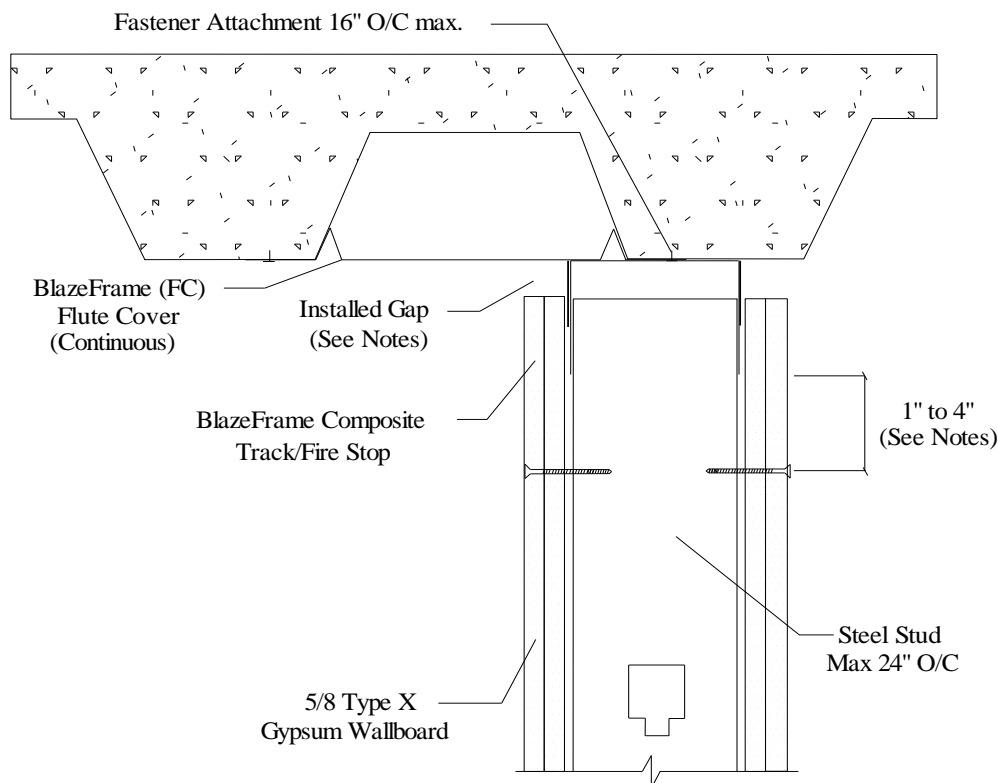

1. Installed Gap (compression only) = movement capability (MC) of profile
2. Installed Gap (compress + extension) = 1/2 movement capability (MC) of profile
3. Attach to substrate with approved fastener max 24" O.C or per E.O.R.
4. Do not screw drywall or stud to BlazeFrame solid leg profile studs "free float"
5. "Slotted" profile metal framing fastener installed center of slot (min. one side)
6. Drywall fasteners 1" to 4" below BlazeFrame to accommodate MC
7. Install min 3" width 4pcf mineral wool comp. 33% to fill above flute cover when "open" end(s)

### UL, ASTM & Code Standards

UL2079, E814, E1966, ULC S115-M95  
A1003, A653, A924, C645, C754, C955  
AISI 2004 NAS  
2006 & 2009 IBC  
2007 CBC

### Leed Points

MR 2.1 & 2.2 - Construction Waste: up to 2 pts  
MR 4.1 & 4.2 - Recycled Content : up to 2 pts  
MR 5.1 & 5.2 - Regional Proximity  
EQ 4.1 - Low Emitting Materials  
EQ 9 - Enhanced Acoustical

Phone: (425) 869-2811 Fax: (425) 869-2300