

UD9 - Centered Under Valley (Unprotected Deck)

Joint Movement Capabilities (MC) / Profile Series refer to UL Listing: [HW-D-0499](#)

3/4" MC - (DL) (SL) (DSL)

1" MC - (DLW) (SLW) (DSLW)

1 1/2" MC - (DLX) (SLX) (DSLX)

2" MC - (DLZ)

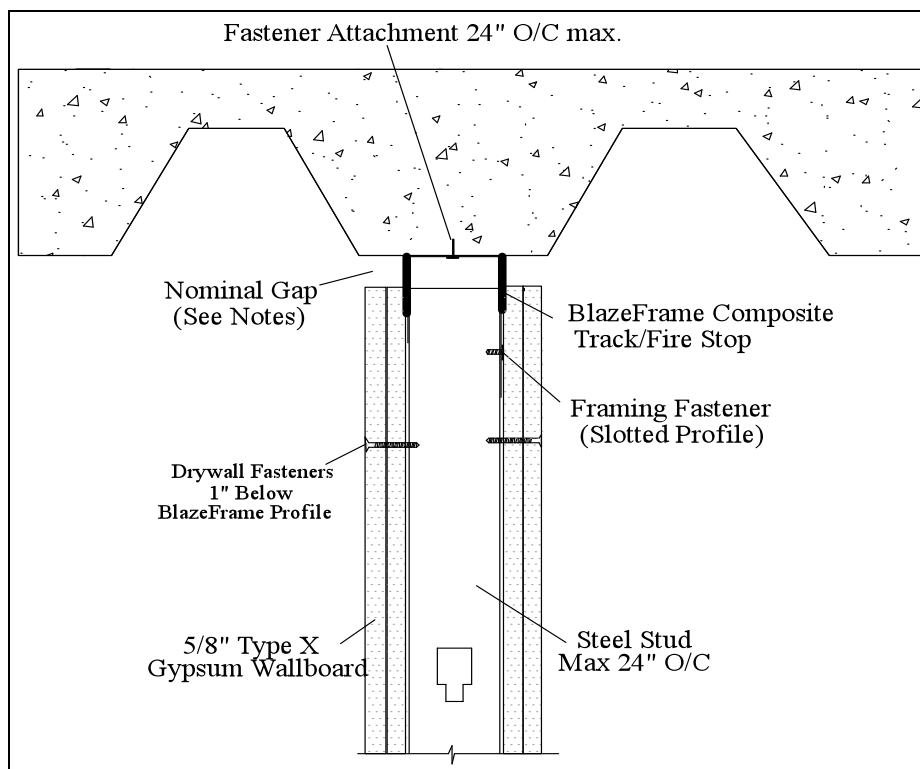

1. Nominal Gap (single story) = movement capability (MC) of profile
2. Nominal Gap (multi-story) = 1/2 movement capability (MC) of profile
3. Attach to substrate with approved fastener max 24" O.C or per E.O.R.
4. Do not screw drywall or stud to BlazeFrame profile
5. "Slotted" profile framing fastener installed center of slot
6. Drywall fasteners 1" below BlazeFrame profile

Project: _____ Architect: _____

Specification Reference: Section [05 _____] [07 _____] [09 _____] Date: _____

Submitted By: _____ Company: _____

UD-9